

## 3.5W Amplified Bluetooth Neckloop V3.0

2015 updated design. Version 3.0.

### V3.0 Improvements

- 1) **music control function added.**  
Bluetooth button control play/pause.  
Short push "Volume +" to previous song, long push to increase volume.  
Short push "Volume -" to next song, long push to reduce volume.
- 2) Mute button works while play music.
- 2) CYou can cancell alarm notice while change volume.  
If volume comes minimum or maximal will make alarm also.

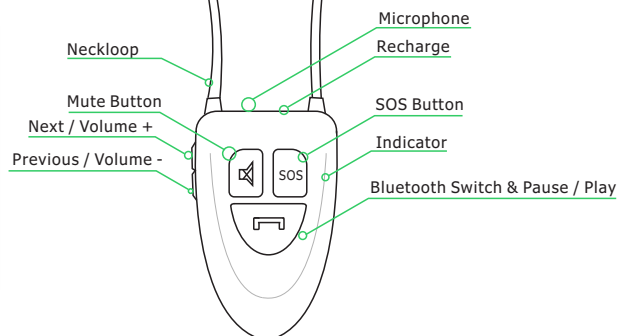

Bluetooth neckloop is build as F class low consumption audio amplifier. Power of amplifier is 3.5watt. It can support all kinds of wireless earpieces and provides very loud audio sounds.

Color available: skin.

Package includes:

- 1 x Amplified Bluetooth Neckloop (skin color)
- 1 x USB recharge cable & 1 x USB AC charger



## Quick Start

### 1 Pair with mobile phone

#### A. Put Bluetooth neckloop in pairing mode

- 1) With the Bluetooth neckloop power off, press and hold Bluetooth switch for 6-10 seconds until indicator turn on and flash between blue and red.
- 2) If Bluetooth is switched on or indicator flashing, press and hold Bluetooth switch for 5 seconds to turn off Bluetooth, then repeat above step 1).

#### B. Put Mobile phone in pairing mode

- 1) Go to mobile phone panel, turn on Bluetooth function and search for new Bluetooth device.
  - 2) Select "T-Loop" then press "OK" or "YES".
  - 3) Enter password "0000" and press "OK".
- \* Once paired, indicator change from flashing to blue.  
Some mobile phone need to "connect" manually after paired.

Note: 1) Bluetooth indicator is nearby "SOS button".

2) If can not switch on Bluetooth, please recharge for 3 hours and try again (refer to "Recharge and Battery").

continued..

## 3.5W Amplified Bluetooth Neckloop V3.0

### 2 Wear the neckloop

Hang the neckloop around the neck as shown in image to the right.

Hang Neckloop around your neck



### 3 Test and use neckloop

Once connected to mobile phone you should be able to hear any audio with your earpieces (Please check how to use earpiece in manual for earpiece). The volume can be adjusted via the volume control on the neckloop.

The Bluetooth neckloop has a number of buttons all providing different functions. See below for detailed descriptions:

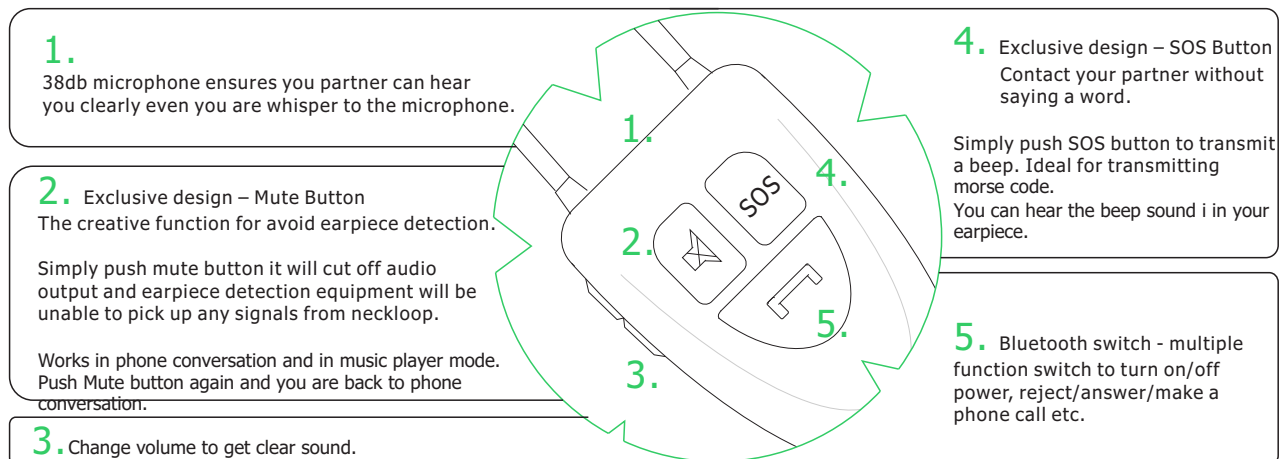

### 4 Power, Battery and recharge

To save battery power, please turn off Bluetooth power if not using for a long period.

**Turn off** – Press and hold Bluetooth switch until indicator flash then switches off

**Turn on** – Press and hold Bluetooth switch until indicator turn Blue. If already paired with mobile phone and Bluetooth function in mobile phone is turned on, it will connect to mobile phone automatically.

*\* Some mobile phone models do not support this function.*

The neckloop has build-in 320mah lithium rechargeable battery. The full performance of a new battery is achieved only after two or three complete charging and discharging cycles. The battery can be charged and discharged hundred of times, but it will eventually wear out.

When recharge battery use only original default USB recharge cable and default wall charger. Do not leave a full charged device on recharge power source. Overcharging may shorten battery life. If left unused, a full charged battery will loss its charge over time.

We supply US/EU standard plugs for the wall charger. Please choose correct plug while placing the order.

continued...

## 3.5W Amplified Bluetooth Neckloop V3.0

5

Operations	
Make a voice dial call	Press Bluetooth switch and speak name after tone
End a call	Tap Bluetooth switch
Receive a call	Tap Bluetooth switch
Reject a call	Press and hold switch until BEEP
Redial last call	Press and hold switch until BEEP
Answer a second incoming call	Press and hold switch (1st call on hold)
Toggle between two active calls	Press and hold switch
Join a 3-way call (depends on phone)	Press and hold both volume swtiches
Put an active call on hold	Press and hold switch until BEEP
Transfer a call from phone to BT	Tap Bluetooth switch
Mute or unmute call	Press Mute button
Send SOS alarm sound	Press SOS button

### Indicators

Solid red (Plugged into Adaptor)	Battery Recharging
No indicator with adaptor plugged in	Charging Completed
No indicator without adaptor plugged in	Power use off
Flash Blue and Red	In pairing mode
10 rapid flashes in Blue	Pairing Successful
Slow pulse in Blue	Connected

## Troubleshooting

### Q. Why the neckloop does not work with my phone?

A. Please make sure the Bluetooth is switched on in your mobile phone and that the neckloop is in pairing mode. Also mobile phone needs to be within 10 meters from Bluetooth neckloop in open space. Restart the phone and neckloop and try again.

### Q. Why do the answer SOS and mute buttons not function?

A. Both of SOS and mute functions only work whilst phone conversation is in progress. If you are playing music or mobile phone not in phone conversation, there 2 functions are not applicable.

### Q. How to recharge battery?

A. Please read "Power, Battery and Recharge" step #4 for detailed instructions. When you have successfully connected the neckloop to a power source the indicator will change to red.

### Q. Why do I hear interference in invisible earpiece?

A. If earpiece has no quality problem, the volume is likely too loud. Reduce the volume on the volume controller.

## Warranty and return policy

**Default warranty is 1 months since the shipping date.**

**We do not accept return if product has not quality problem.**

If product is within warranty and get broken, you can return back and get free repair. Return shipping cost is on buyer's behalf. We will pay the shipping cost for sending product for repair.

If product warranty expired, you need to pay return shipping cost, repair fee and shipping cost for returning repaired product.

**Warranty will be invalid in below conditions:**

- 1) Passed 12 months since ship date.
- 2) Open case or and change circuits without our formal authorization.
- 3) Other kinds of problems caused by wrong operations.

Thank you for reading and Happy eCommerce!